



Weaver

CONSTRUCTION MANAGEMENT

3679 S Huron Street, Suite 404 Englewood, Colorado 80110

Phone: (303) 789-4111 FAX: (303) 789-4310

SUBMITTAL TRANSMITTAL

May 31, 2012

Submittal No: 14600-001.A

PROJECT: **Harold Thompson Regional WRF**
Birdsall Rd.
Fountain, CO 80817
Job No. 2908

ENGINEER: **GMS, Inc.**
611 No. Weber St., #300
Colorado Springs, CO 80903
719-475-2935 Roger Sams

OWNER: **Lower Fountain Metropolitan
Sewage Disposal District**
901 S. Santa Fe Ave.
Fountain, CO 80817
719-382-5303 James Heckman

CONTRACTOR: **Wazee Crane**
2 Santa Fe Drive
Denver, CO 80223
303-632-1736 Jeff Kimling
JKimling@wazee crane.com

SUBJECT: Resubmittal for the Hoist & Trolley at the Headworks Building.

Note: Wazee is submitting a 2 ton in lieu of the 1.5 ton requested in the 2/2/12 review comments. This was discussed and approved for submittal in the 5/31/12 progress meeting.

SPEC SECTION: 14600: Hoist & Trolleys

PREVIOUS SUBMISSION DATES: 2/2/12

DEVIATIONS FROM SPEC: YES NO

CONTRACTOR'S STAMP: This submittal has been reviewed by Weaver Construction Management and, unless indicated otherwise, has been found to be in conformance with the intent of the contract documents .

Contractor's Stamp:

Engineer's Stamp:

Date: 5/31/12

Reviewed by: Leslie Brown

(X) Reviewed Without Comments

() Reviewed With Comments

ENGINEER'S
COMMENTS:

Wazee Crane Submittal Information

HAROLD THOMPSON WRF

WEAVER CN

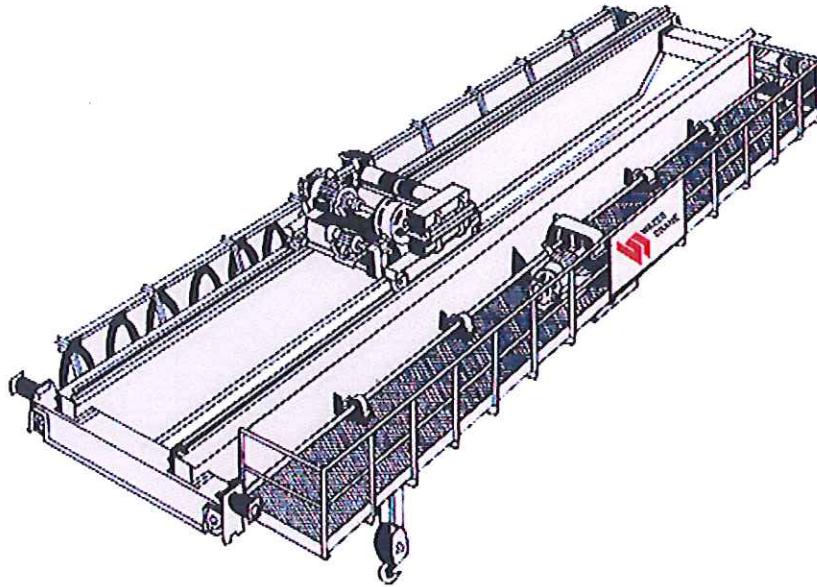

Wazee Crane
2 Santa Fe Drive
Denver, CO 80223
Phone: (800)-624-1736
Fax: (303)-623-1055
Job Number: 14600-001

DIVISION 14

CM MANUAL HAND CHAIN HOIST WITH MANUAL PUSH TROLLEY

HOIST MODEL: 622

PRODUCT CODE: 2258

CAPACITY: 2 TON

LIFT: 22'0"

HAND CHAIN DROP: 16'0"

TROLLEY MODEL: CBPT-0200

CAPACITY: 2 TON

FLANGE WIDTH: 6"

Series 622 hand chain hoist

- Simple, efficient, economical design
- Equipped with hardened load chain for flexibility and long wear
- Compact design, low headroom and lightweight steel construction for easy installation, even in confined spaces
- Weston-type load brake requires no lubrication
- Hand wheel cover with guide slots minimizes jamming and slipping
- Forged swivel hooks with latches reduce twisting of chain and unintentional unhooking of load when chain is slack
- Standard hand chain drop is 2 feet less than lift (example: 8 foot lift hoist has 6 foot hand chain drop)
- One-year warranty
- Metric rated
- Imported

Specifications

Product code	Rated capacity* (tons)	Standard lift (ft.)	Chain pull to lift rated load (lbs.)	Hand chain overhauled to lift load one foot (ft.)	Approx. shipping weight (lbs.)
2255	1/2	10	53	29	18
2208	1/2	15	53	29	25
2231	1/2	20	53	29	30
2263	1/2	30	53	29	38
2256	1	10	77	37	26
2210	1	15	77	37	30
2262	1	20	77	37	38
2264	1	30	77	37	48
2258	2	10	82	80	61
2213	2	15	82	80	71
2233	2	20	82	80	80
2272	2	30	85	80	85
2259	3	10	65	154	89
2223	3	15	65	154	99
2214	3	20	65	154	109
2260	5	10	105	147	91
2257	5	15	105	147	107
2234	5	20	105	147	123
2277	10	10	109	289	170



Series 622 hand chain hoist-specifications

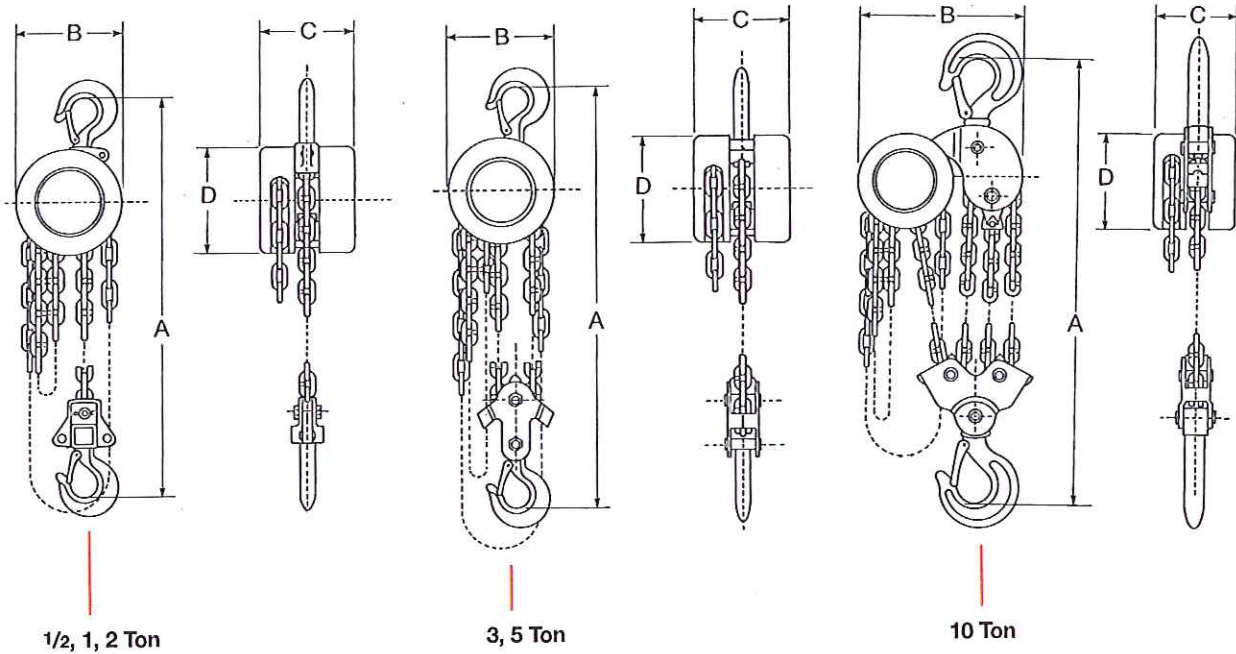

***WARNING**

Overloading and improper use can result in injury.

To avoid injury:

- Do not exceed working load limit, load rating capacity
- Do not use to lift people or loads over people.
- use only alloy chain for overhead lifting.
- Read and follow all instructions.

Clearance dimensions (in.)

Dimension	Rated capacity* (tons)					
	1/2	1	2	3	5	10
A (Headroom)	11 ⁵ / ₈	13	18 ¹ / ₈	21 ²⁹ / ₃₂	23 ⁷ / ₈	27 ⁹ / ₁₆
B (Width)	4 ¹⁵ / ₁₆	5 ¹⁹ / ₃₂	8 ⁵ / ₁₆	8 ⁵ / ₁₆	8 ⁵ / ₁₆	14 ³ / ₃₂
C (Depth)	4 ⁵ / ₁₆	5 ¹ / ₁₆	6 ⁵ / ₈	6 ⁵ / ₈	6 ⁵ / ₈	6 ⁵ / ₈
D (Diameter)	4 ¹⁵ / ₁₆	5 ¹⁹ / ₃₂	8 ⁵ / ₁₆	8 ⁵ / ₁₆	8 ⁵ / ₁₆	8 ⁵ / ₁₆
Hook opening (upper)	1 ¹ / ₁₆	1 ¹ / ₃₂	1 ¹ / ₄	5 ¹ / ₁₆	1 ¹³ / ₁₆	2 ¹ / ₂
Hook opening (lower)	1 ¹ / ₁₆	1 ¹ / ₃₂	1 ¹ / ₄	5 ¹ / ₁₆	1 ¹³ / ₁₆	2 ¹ / ₂

CBT Trolley

Plain or Geared Trolleys – Versatile, Economical, and Reliable

The smooth rolling CM Hoist CBT is the economical choice for most applications. The trolley features steel wrap around side plates, dual tread wheels and lifetime lubricated shielded ball bearings. The CBT Model by CM Hoist is available in plain and geared models.

- **Capacities** - Rated loads from 1/4 to 5 Ton (Metric Rated). In plain and geared models.
- **Economical** - Excellent low cost choice for manual and powered hoists.
- **Rugged** - Designed to provide superior performance and long, efficient service.
- **Low Rolling Effort** - Geared models have standard 6-foot hand chain drop. Other hand chain drops available.
- **Universal Hanging Clevis** - Accepts most hook mounted hoists.
- **Adjustable** - Trolley easily adjusts to fit any beam flange within range of adjustment, up to an 8.7" flange width.
- **Wrap-Around Side Plates** - Lugs provide additional security to increase operator safety and act as bumpers to protect wheels.
- **Dual Tread Wheels** - Will fit either tapered or flat beam flange within range of adjustment. Wheels include permanently lubricated, shielded ball bearings for long life and low maintenance.
- **Lifetime Warranty**

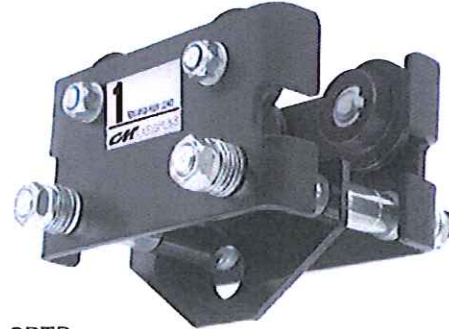

CBTP
(Plain Trolley)
1/4 To 5 Ton



CBTG
(Geared Trolley)
1 To 5 Ton

SPECIFICATIONS - Model CBT

Capacity* (Ton)	Plain Product Code**	Geared Product Code**	Standard Beam Height (In.)	I-Beam Width (In.)	Minimum Radius Curve (In)	Wheel Tread Diameter (In)	Wt. (Lb.)
1/4	CBT(P)-0025		4-24	2.0-8.7	27	2.36	19
1/2	CBT(P)-0050		4-24	2.0-8.7	27	2.36	19
1	CBT(P)-0100	CBT(G)-0100	5-24	2.3-8.7	36	2.36	26
1 1/2	CBT(P)-0150	CBT(G)-0150	6-24	2.3-8.7	45	3.15	46
2	CBT(P)-0200	CBT(G)-0200	6-24	2.3-8.7	45	3.15	46
3	CBT(P)-0300	CBT(G)-0300	8-24	3.0-8.7	55	4.41	86
5	CBT(P)-0500	CBT(G)-0500	10-24	3.5-8.7	70	4.92	130

* Metric Rated

**When ordering specify "P" for plain trolley or "G" for geared trolley

CBT Trolley - Specifications

Dimensional Drawing - 602

Model CBTP/CBTG 1/4-5 Metric Ton

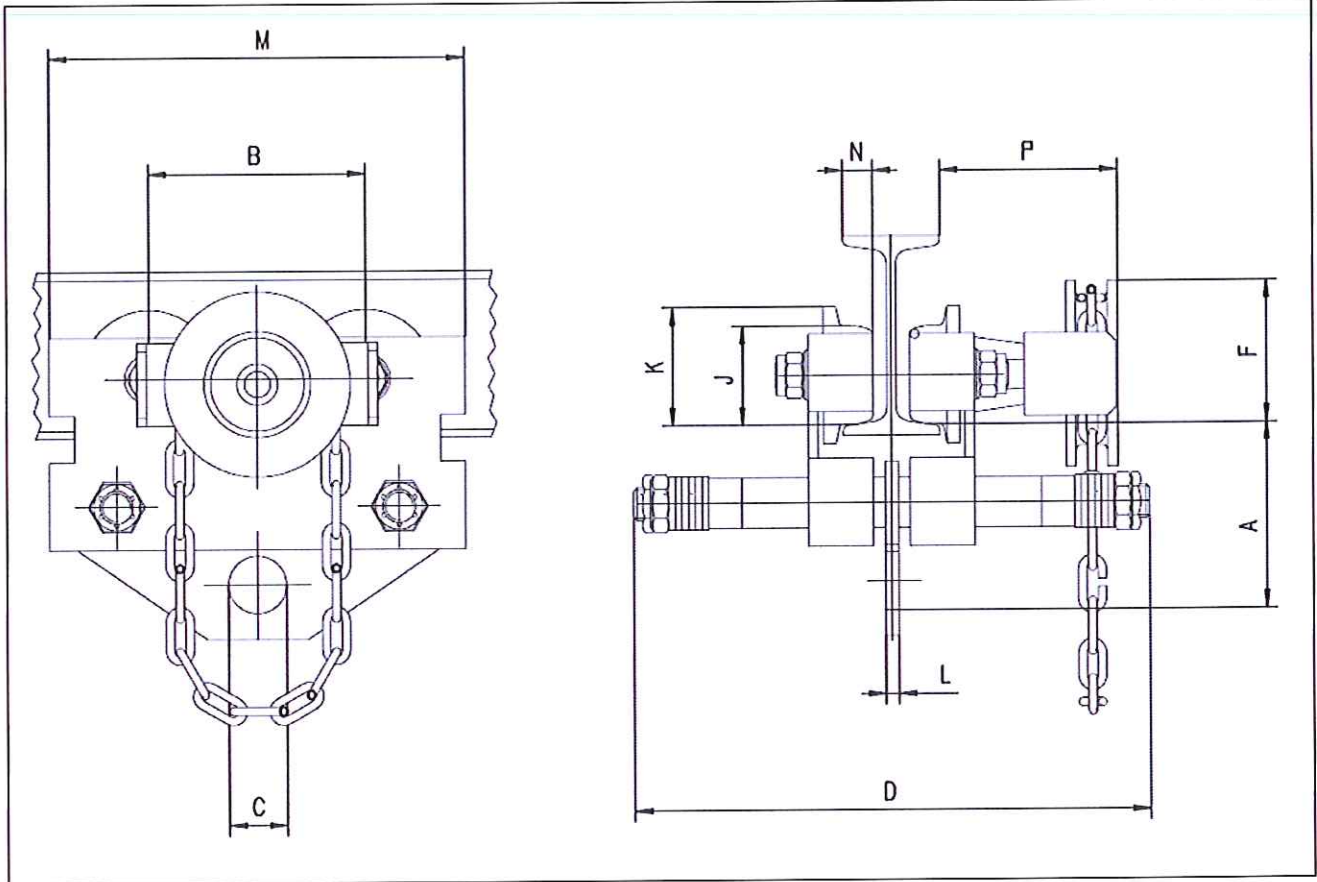

Clearance Dimensions (In.)

Model CBT

Capacity (Ton)	A	B	C	D	CBTG F	J	K	CBTG K	L	M	N	CBTG P
1/4	3.94	3.54	1.18	11.81	-	2.36	2.83	-	.31	7.56	.71	-
1/2	3.94	3.54	1.18	11.81	-	2.36	2.83	-	.31	7.56	.71	-
1	4.33	5.12	1.38	12.20	3.60	2.36	2.83	3.03	.31	9.84	.71	4.33
1 1/2	5.12	5.91	1.89	12.60	3.56	3.15	3.78	3.86	.47	11.81	.79	4.33
2	5.12	5.91	1.89	12.60	3.56	3.15	3.78	3.86	.47	11.81	.79	4.33
3	6.18	7.09	2.36	13.39	4.23	4.41	5.20	5.24	.55	14.57	1.14	4.33
5	7.09	8.23	2.76	13.78	5.89	4.92	5.63	5.87	.79	17.32	1.26	4.33