



WEAVER GENERAL CONSTRUCTION COMPANY
 3679 S. Huron St., Suite 404
 Englewood, CO 80110
 Phone: (303) 789-4111 FAX: (303) 789-4310

SUBMITTAL TRANSMITTAL

May 24, 2011

WGC Submittal No: 03100-004

PROJECT: **Harold Thompson Regional WRF**
 Birdsall Rd.
 Fountain, CO 80817
 Job No. 2908

ENGINEER: **GMS, Inc.**
 611 No. Weber St., #300
 Colorado Springs, CO 80903
 719-475-2935 Roger Sams

OWNER: **Lower Fountain Metropolitan
 Sewage Disposal District**
 901 S. Santa Fe Ave.
 Fountain, CO 80817
 719-382-5303 James Heckman

CONTRACTOR: **Garney Companies Inc.**
 7911 Shaffer Parkway
 Littleton, CO 80127
 303-791-3600 Dennis Van Auken

SUBJECT: Concrete Formwork for Clarifiers

SPEC SECTION: 03100 - Concrete Formwork

PREVIOUS SUBMISSION DATES: None

DEVIATIONS FROM SPEC: ___ YES X NO

CONTRACTOR'S STAMP: This submittal has been reviewed by Weaver General Construction and approved with respect to the means, methods, techniques, & safety precautions & programs incidental thereto. Weaver General Construction also warrants that this submittal complies with contracted documents and comprises on deviations thereto:

Contractor's Stamp:

Date: 5/
 Reviewed by: H.C. Myers
 (X) Reviewed Without Comments
 () Reviewed With Comments

**ENGINEER'S
 COMMENTS:** _____

Engineer's Stamp:

ELLIS

Construction Specialties, Ltd.

PRO-FORM

Concrete Forming System

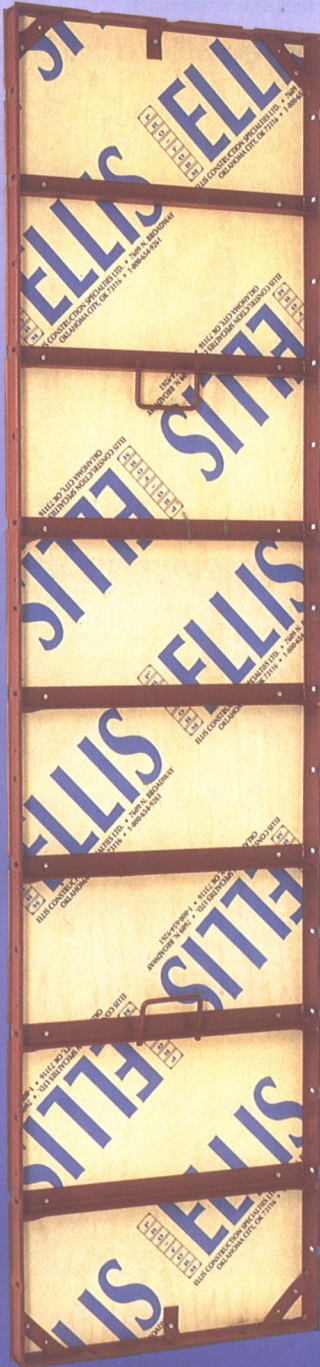

- Easy to Erect
- Re-Usable
- Handset or Gang Form
- Versatile for any Size or Shape

ELLIS Construction Specialties has been manufacturing concrete forming and shoring systems since 1964.

ELLIS CONSTRUCTION SPECIALTIES, LTD.

7609 N. BROADWAY

OKLAHOMA CITY, OK 73116

405/848-4676 • 1-800-654-9261

web site: www.ellisforms.com • e-mail: info@ellisforms.com

MADE IN U.S.A.

ELLIS PRO-FORM

ELLIS Pro-Form is a reusable, modular concrete forming system. It is versatile and can be hand set or gang formed, to fit your job requirements. Pro-Form is designed to handle a variety of jobs from residential to commercial projects. It works great for almost any size or shape of wall including columns and round tanks. Special 2000psf column forms are available for purchase only. Whatever type of structure you are forming you will find that Pro-Form will fit your needs.



Pro-Form is ideal on smaller jobs where easy set-up and stripping saves time with virtually no sawing, drilling or nailing required.



Pro-Form is easily used in Gang Form Applications.

Pro-Form Basic Features

Pro-Form is a 1,000 PSF System

Fast and Easy Hardware Connections

High Carbon Steel for Years of Use

Compatible with Symons Steel-Ply and Patent Mod-U-Form

1/2" 100/30 HDO Plywood

All plywood edges are polyurethane sealed for protection against moisture

Handles for ease in transporting, positioning and stripping

Handles are not to be used for climbing or connecting fall protection devices.

Pro-Form Hardware & Accessories

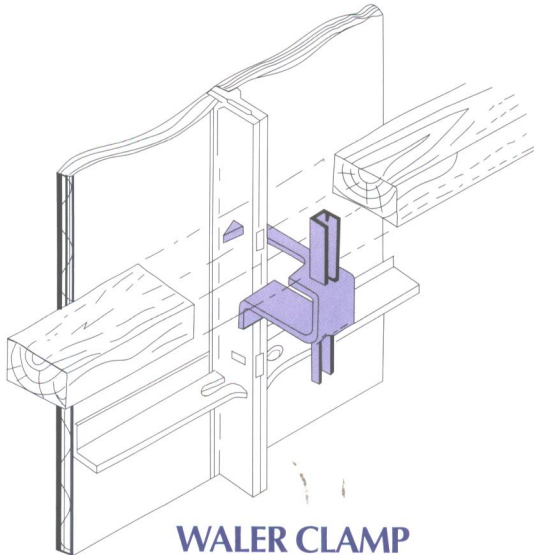

WALER CLAMP

One Piece Waler Clamps are fast and simple. They are used to align forms by laying a single or double 2" x 4" on clamps and tightening with a hammer. Waler one side of the wall for a single tier of forms.

WEDGE BOLT

When hand setting, wedge bolts are only needed to hold forms together where ties are used.

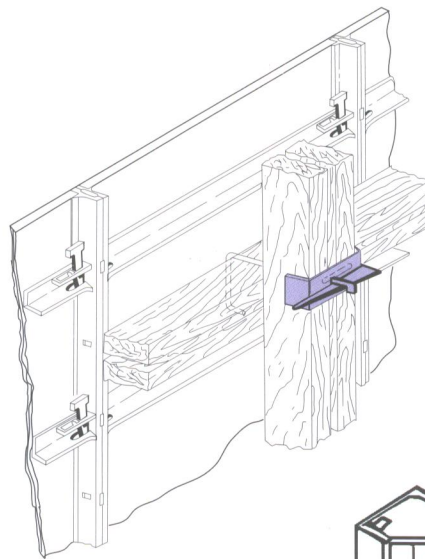
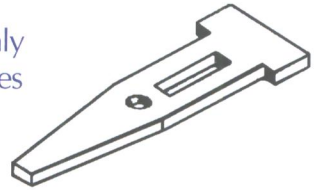

J-STRONGBACK HOOKS

J-Strongback hooks are used to attach vertical strongbacks to horizontal walers. Strongbacks are only needed when stacking forms.

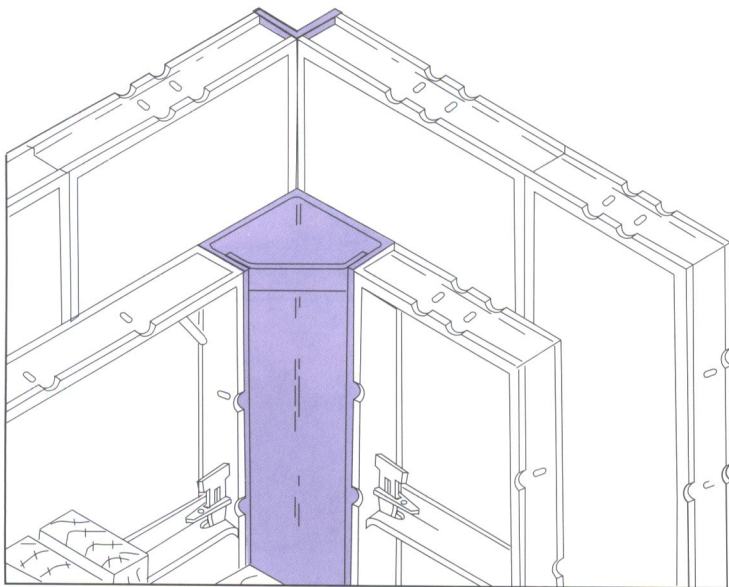

Both inside and outside corners are attached just as easily as attaching forms together using wedge bolts.

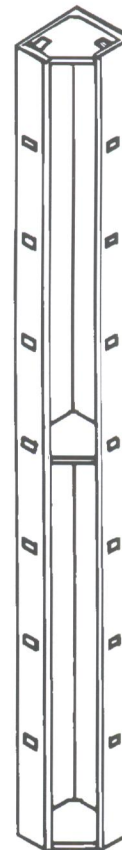

INSIDE CORNER



OUTSIDE CORNER

Pro-Form Fillers

ELLIS has 105 different panel and filler sizes for sale or rent, providing you with the best fit for each of your job requirements. We do our own manufacturing so when you need something out of the ordinary we can work with you to design and build forms and shoring to your exact specification.

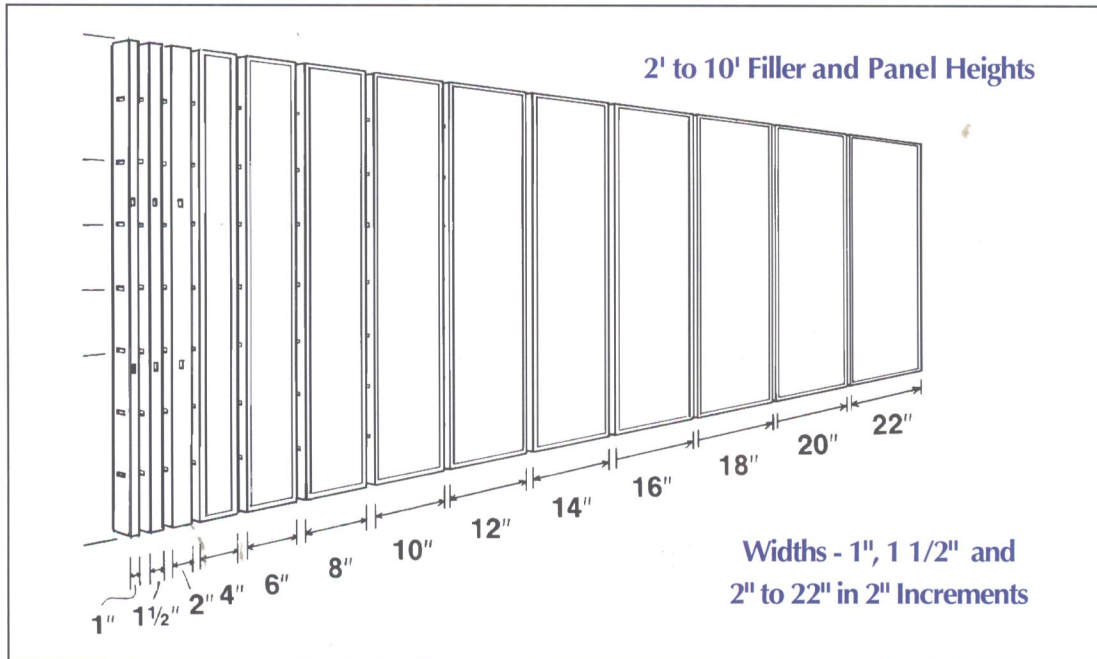

Pro-Form Ties

- Loop Panel
- Gang Loop Panel
- Loop Panel with Cone
1", 1 1/2", 2" cones available
- Base Ties
- X-Flat Ties
1/4" Break Back



| | ULTIMATE LOAD | WORKING LOAD ACCORDING TO SAFETY FACTORS | |
|------------------------|---------------|--|------|
| | | 1.5 | 2.0 |
| Standard Duty Wire Tie | 4500 | 3000 | 2250 |
| Heavy Duty Wire Tie | 6000 | 4000 | 3000 |
| Base Tie | 3000 | 2000 | 1500 |
| Standard Duty Flat Tie | 6000 | 4000 | 3000 |
| Heavy Duty Flat Tie | 7000 | 4500 | 3500 |

WEBSITE INFORMATION...

www.ellisforms.com info@ellisforms.com

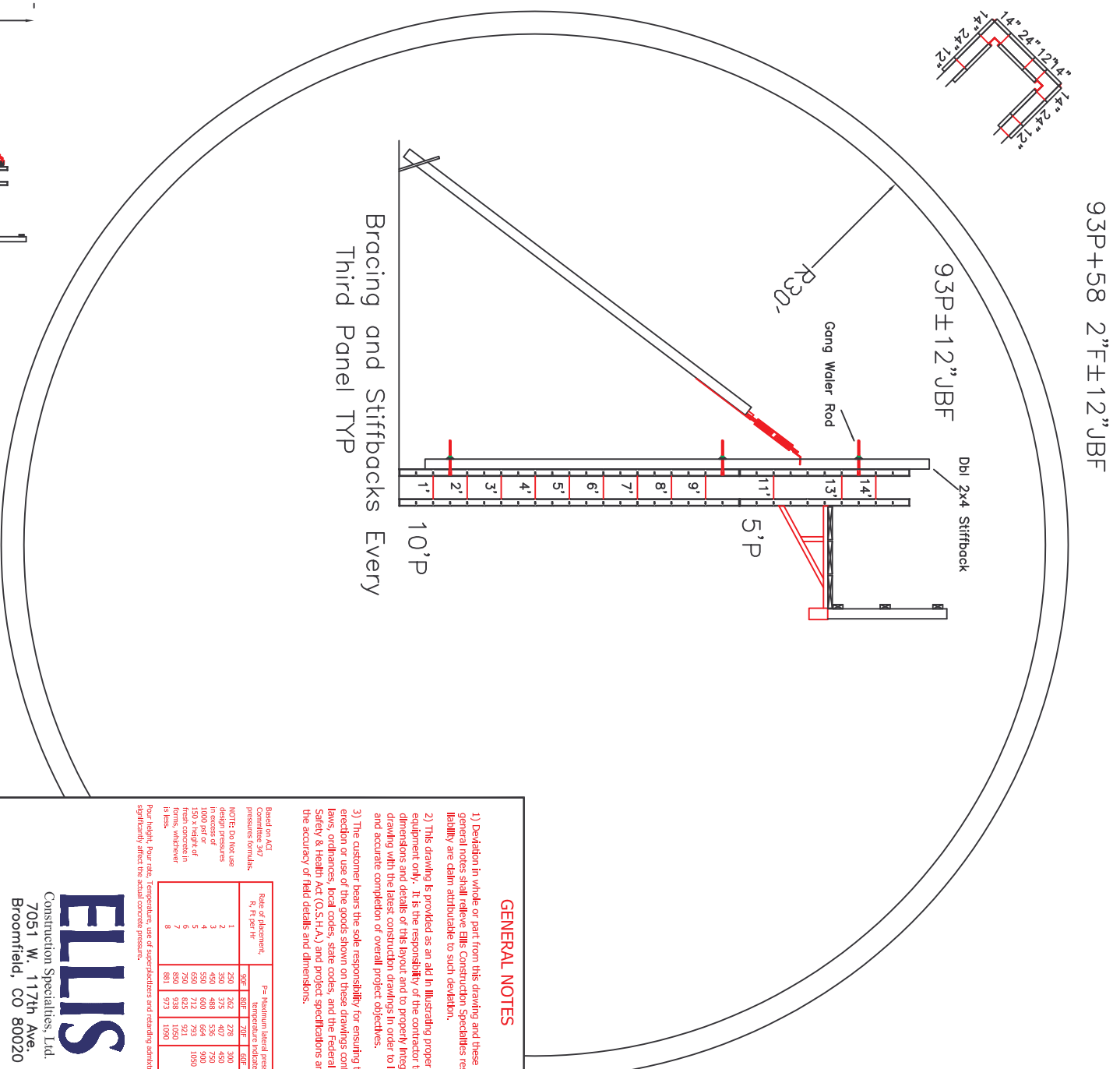
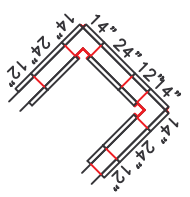
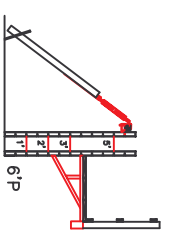
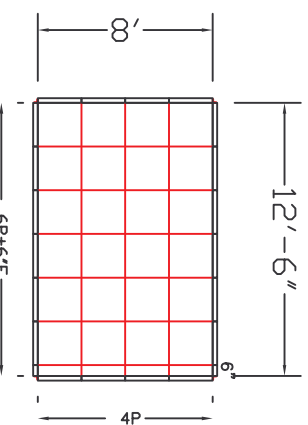
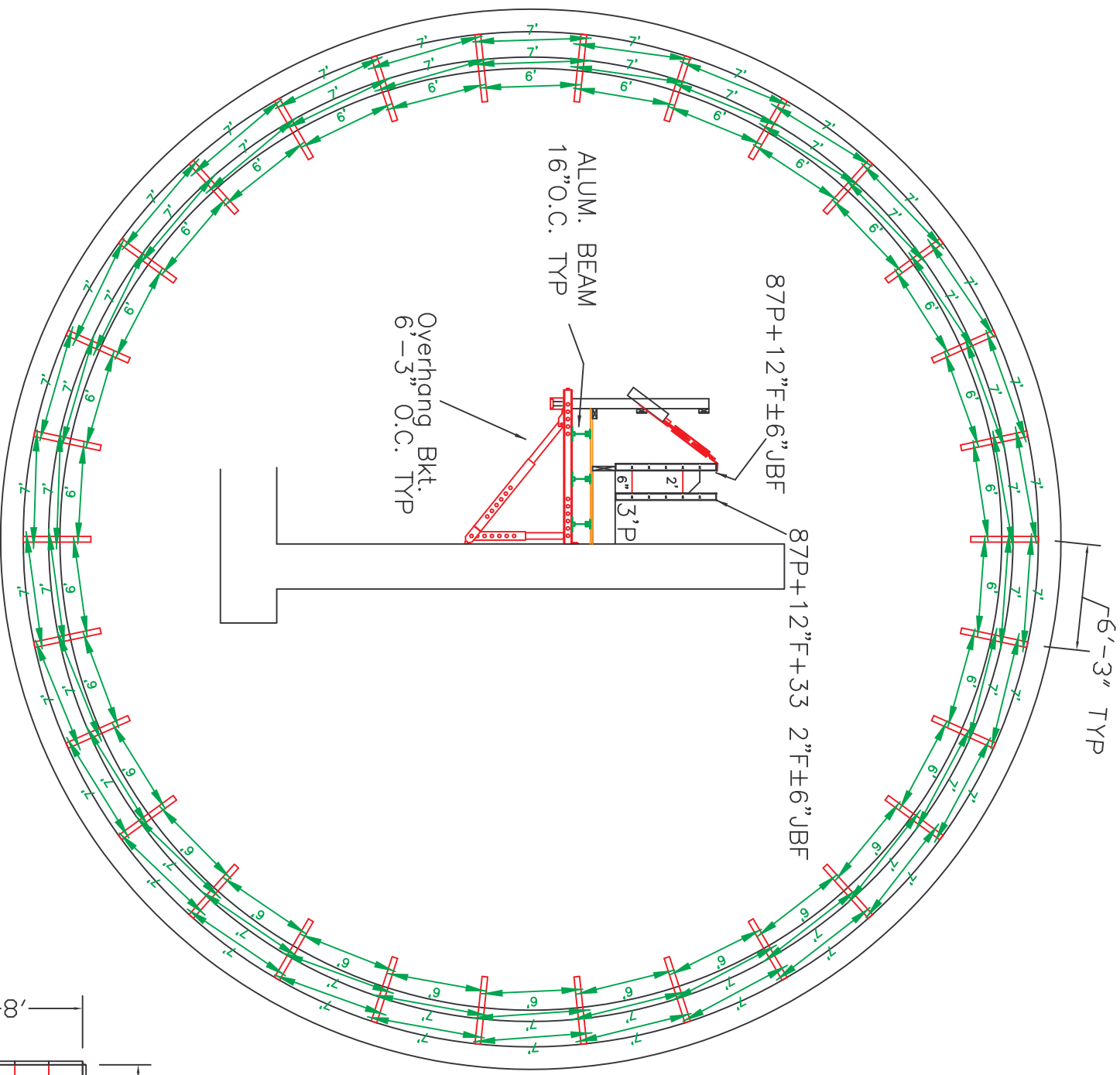

GENERAL NOTES

- 1) Deviation in whole or part from this drawing and these general notes shall relieve Ellis Construction Specialists responsibility, liability are claim attributable to such deviation.
- 2) This drawing is provided as an aid in illustrating proper erection of equipment and details of this layout and to properly integrate this drawing with the best construction drawings in order to insure safe and accurate completion of overall project objectives.
- 3) The customer bears the sole responsibility for ensuring that any erection or use of the goods shown on these drawings conforms to all laws, ordinances, local codes, state codes, and the Federal Occupational Safety & Health Act (O.S.H.A.) and project specifications and for checking the accuracy of field details and dimensions.

Based on ACI Concrete 307
 R, F, per ft²

| Rate of aluminum, R, F, per ft ² | P = Maximum lateral pressure, per ft ² |
|---|---|
| 1 | 250 262 278 300 338 375 |
| 2 | 450 468 492 525 580 650 |
| 3 | 650 675 705 750 825 925 |
| 4 | 850 885 930 1000 1100 1250 |
| 5 | 1050 1100 1160 1250 1375 1550 |
| 6 | 1250 1310 1380 1480 1625 1825 |
| 7 | 1450 1520 1600 1710 1875 2100 |
| 8 | 1650 1730 1820 1940 2125 2375 |

NOTE: Do not use in excess of 1000 psf or 150 x height of form, whichever is less.
 Pour height, Pour rate, Temperature, use of superplasticizers and retarding admixtures significantly affect the actual concrete pressure.

ELLIS
 Construction Specialists, Ltd.
 7051 W, 117th Ave.
 Broomfield, CO 80020

(800) 562-1740 (303) 460-1366
 Garney Const.

HDT WRF
 Clarifiers

SCALE No scale DATE 05/20/11