



**WEAVER CONSTRUCTION MANAGEMENT, INC.**

3679 S. Huron St., Suite 404  
Englewood, CO 80110  
Phone: (303) 789-4111 FAX: (303) 789-4310

**SUBMITTAL TRANSMITTAL**

August 2, 2011

WGC Submittal No: 03200-008.A

**PROJECT:** Harold Thompson Regional WRF  
Birdsall Rd.  
Fountain, CO 80817  
Job No. 2908

**ENGINEER:** GMS, Inc.  
611 No. Weber St., #300  
Colorado Springs, CO 80903  
719-475-2935 Roger Sams

**OWNER:** Lower Fountain Metropolitan  
Sewage Disposal District  
901 S. Santa Fe Ave.  
Fountain, CO 80817  
719-382-5303 James Heckman

**CONTRACTOR:** Dalco Industries Inc.  
3730 Salem Street  
Denver, CO 80239  
303-371-3950 David Tarin

**SUBJECT:** Resubmittal: Revision 1 for CMU Plan, Sitework & Wall Elevation Drwgs at Headworks Bldg. (M1, M2)

**SPEC SECTION:** 03200 - Concrete Reinforcement

**PREVIOUS SUBMISSION DATES:** None

**DEVIATIONS FROM SPEC:** \_\_\_ YES  X  NO

**CONTRACTOR'S STAMP:** This submittal has been reviewed by Weaver General Construction and approved with respect to the means, methods, techniques, & safety precautions & programs incidental thereto. Weaver General Construction also warrants that this submittal complies with contracted documents and comprises on deviations thereto:

---

**Contractor's Stamp:**

---

**Engineer's Stamp:**

Date: 8/2/11  
Reviewed by: H.C. Myers  
( X ) Reviewed Without Comments  
( ) Reviewed With Comments

**ENGINEER'S  
COMMENTS:** \_\_\_\_\_

---

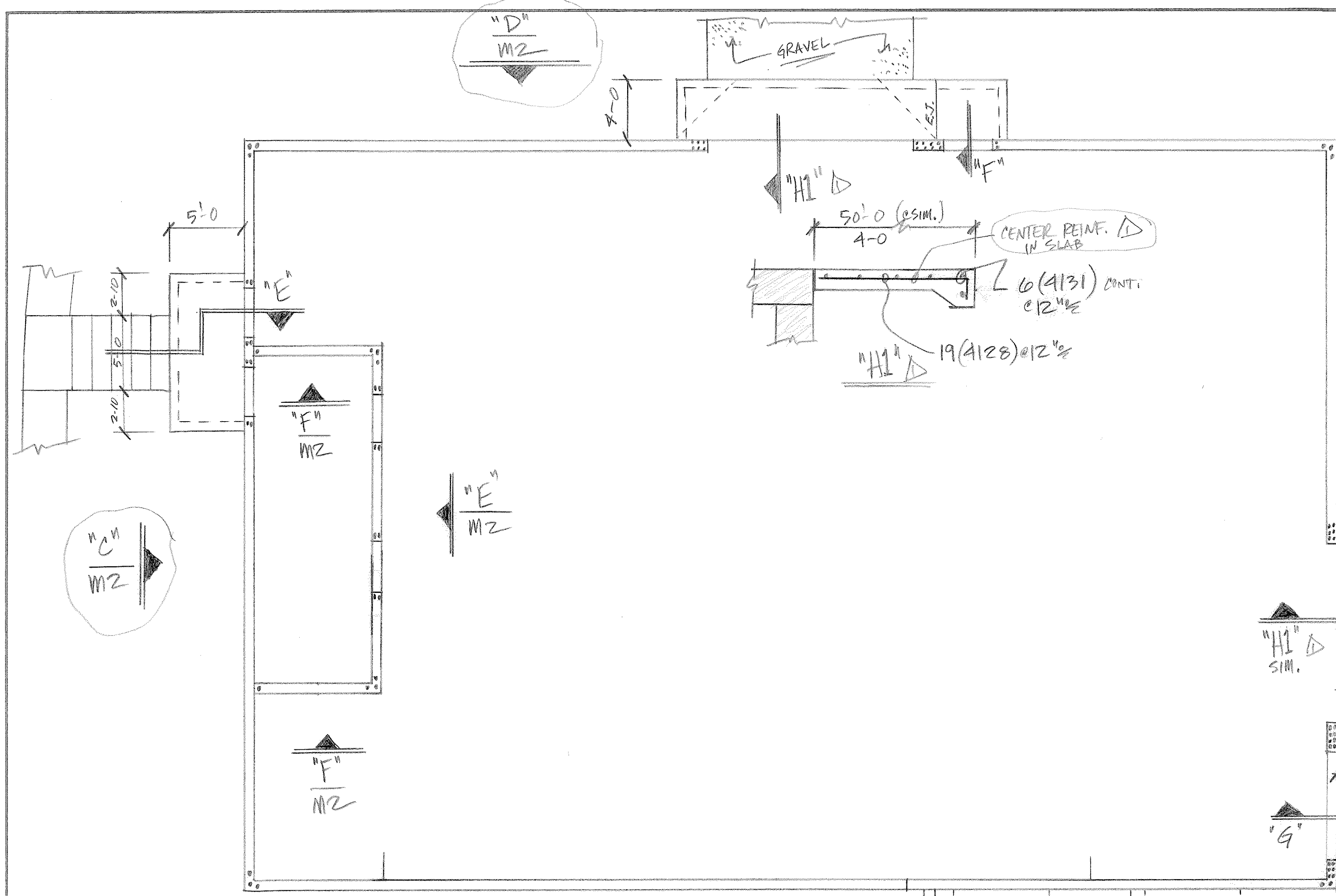

QTY	SIZE	TYPE	LENGTH FT. - IN.	MARK	SKETCH	A	B	C	D	E	F/R	G	H	K	J	O
5	17		5123		7		2-0	2-0								
4	17		4124		7		2-0	1-6	2-0							
4	17		4125		7		2-0	1-6								
4	17		4126		7		1-6	1-6								
6	17		6127		L		2-8	3-10								
4	17		4128		7		0-6 1/2	3-8								
4	17		4129		7		0-7 1/2	3-8	Δ							
4	17		4130		7		0-7 1/2	4-6								
4	17		4131		7		0-6 1/2	17-3								
4	17		4132		7		0-7 1/2	10-4	0-7 1/2							
4	17		4133		7		0-7 1/2	4-8								
4	3		4134		7		2-0	3-0					1-2	+		
4	27		4135		7			3-0	3-4				0-7 1/2	1-2	+	
4	17		4136		7		0-7 1/2	3-0								

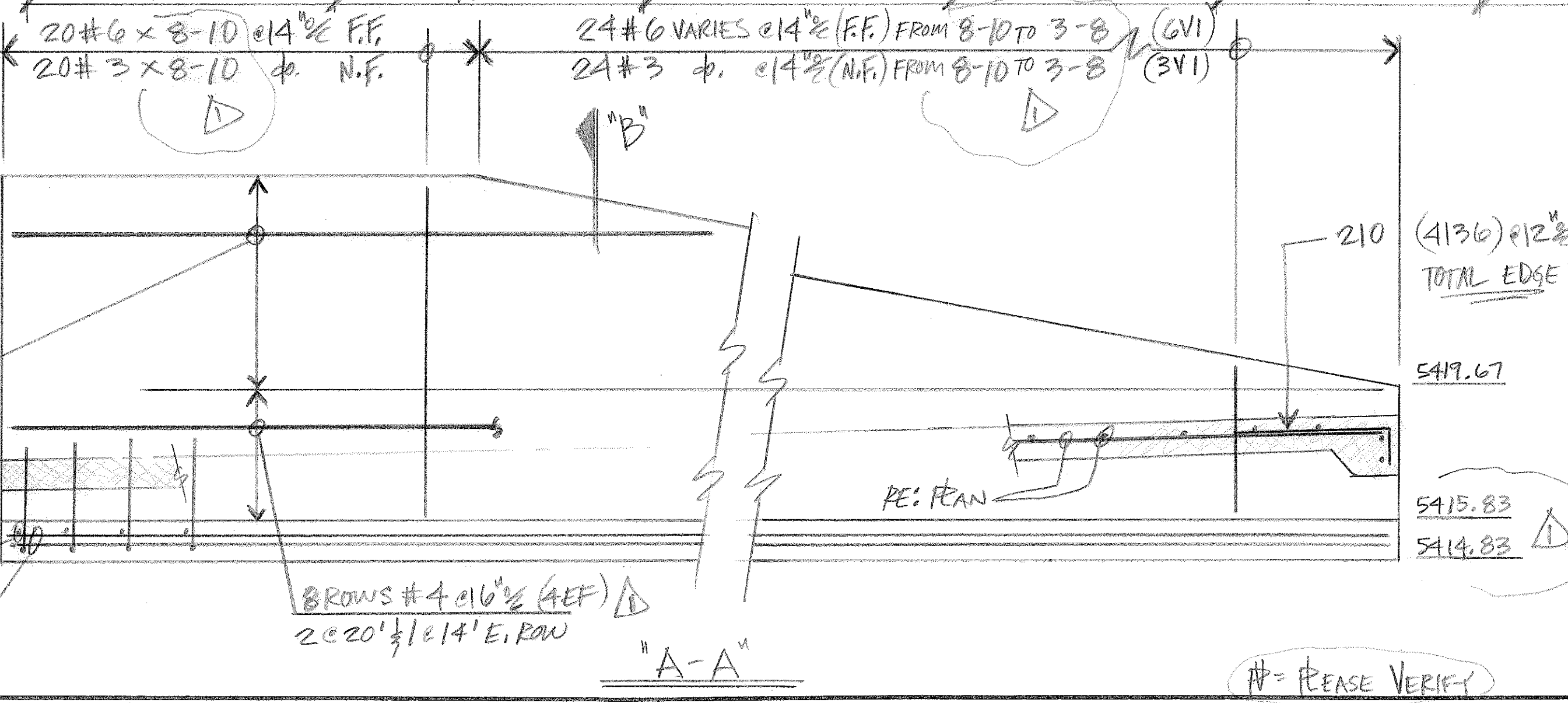
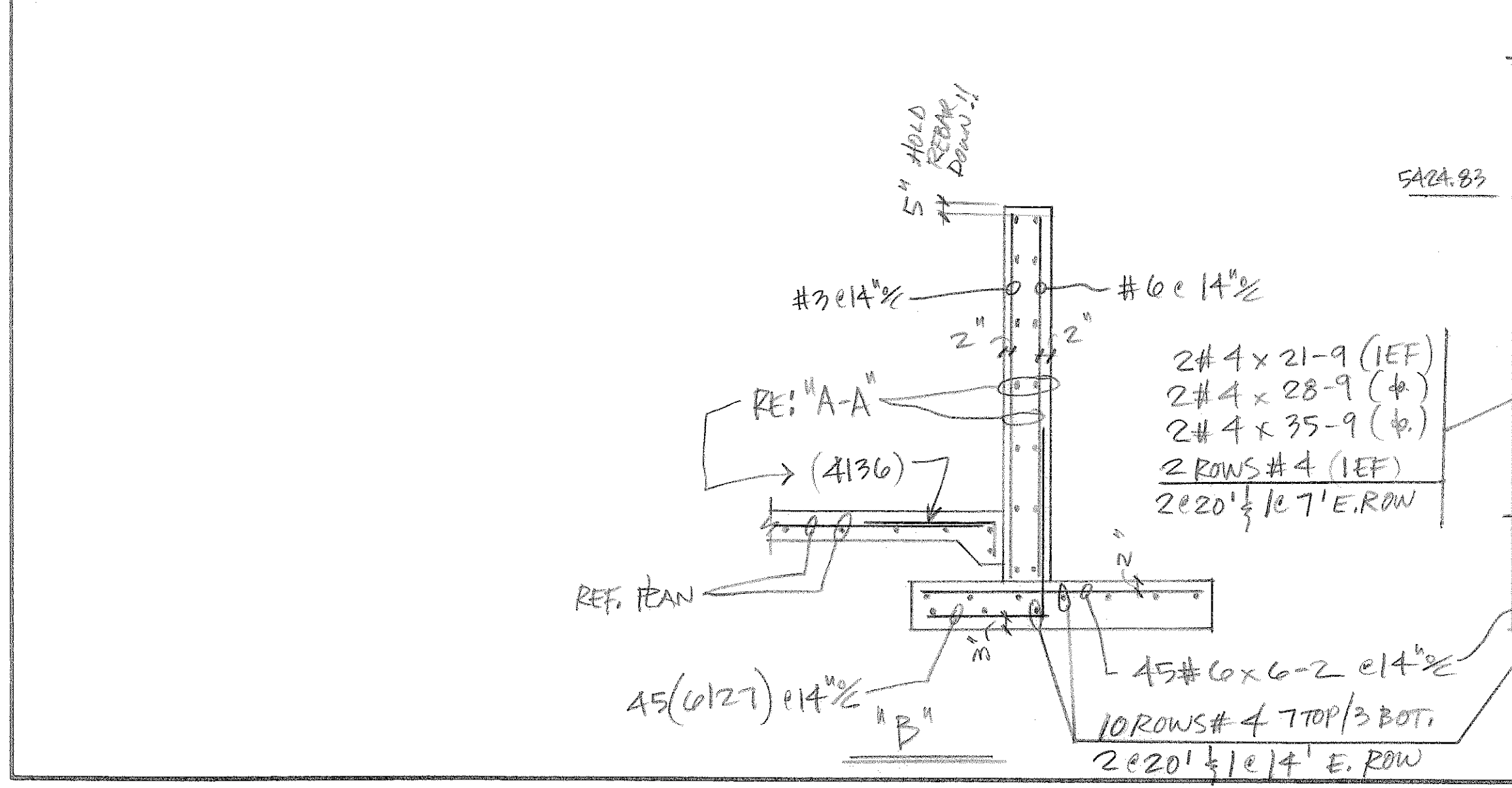
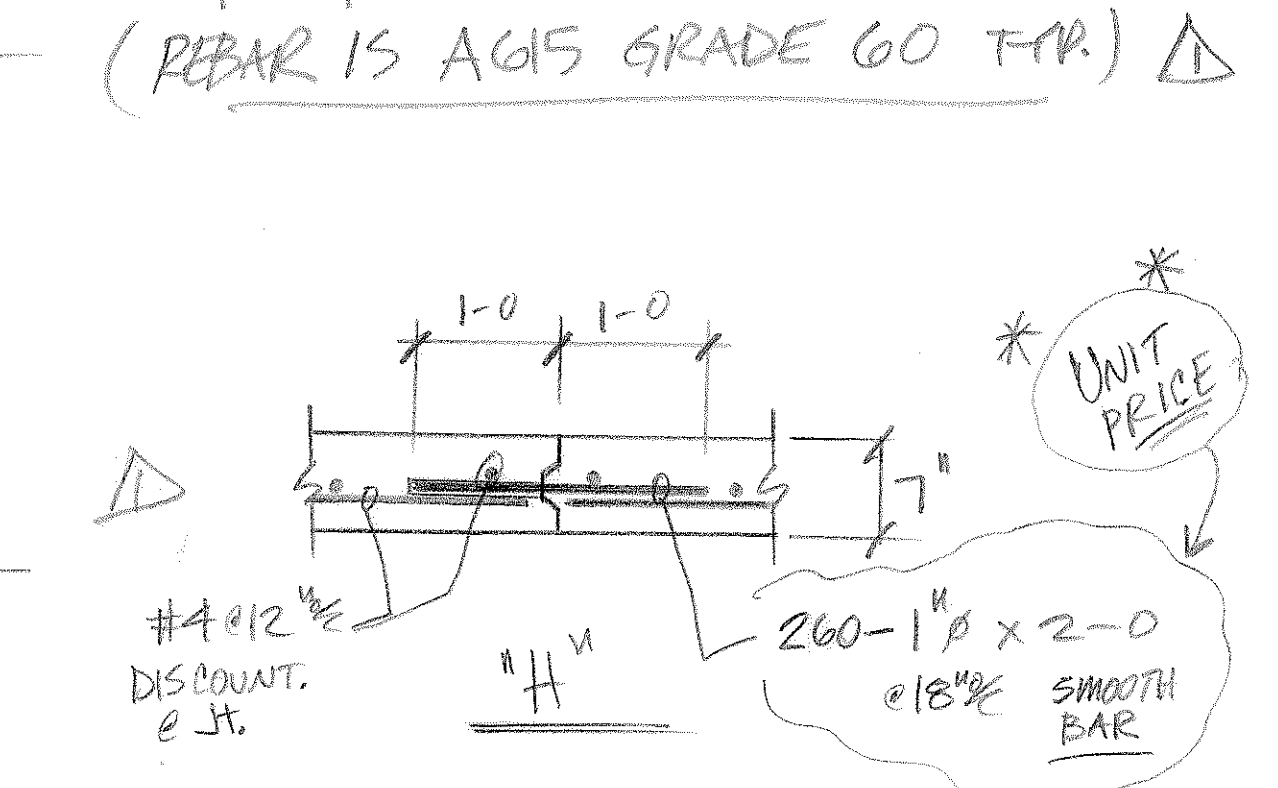
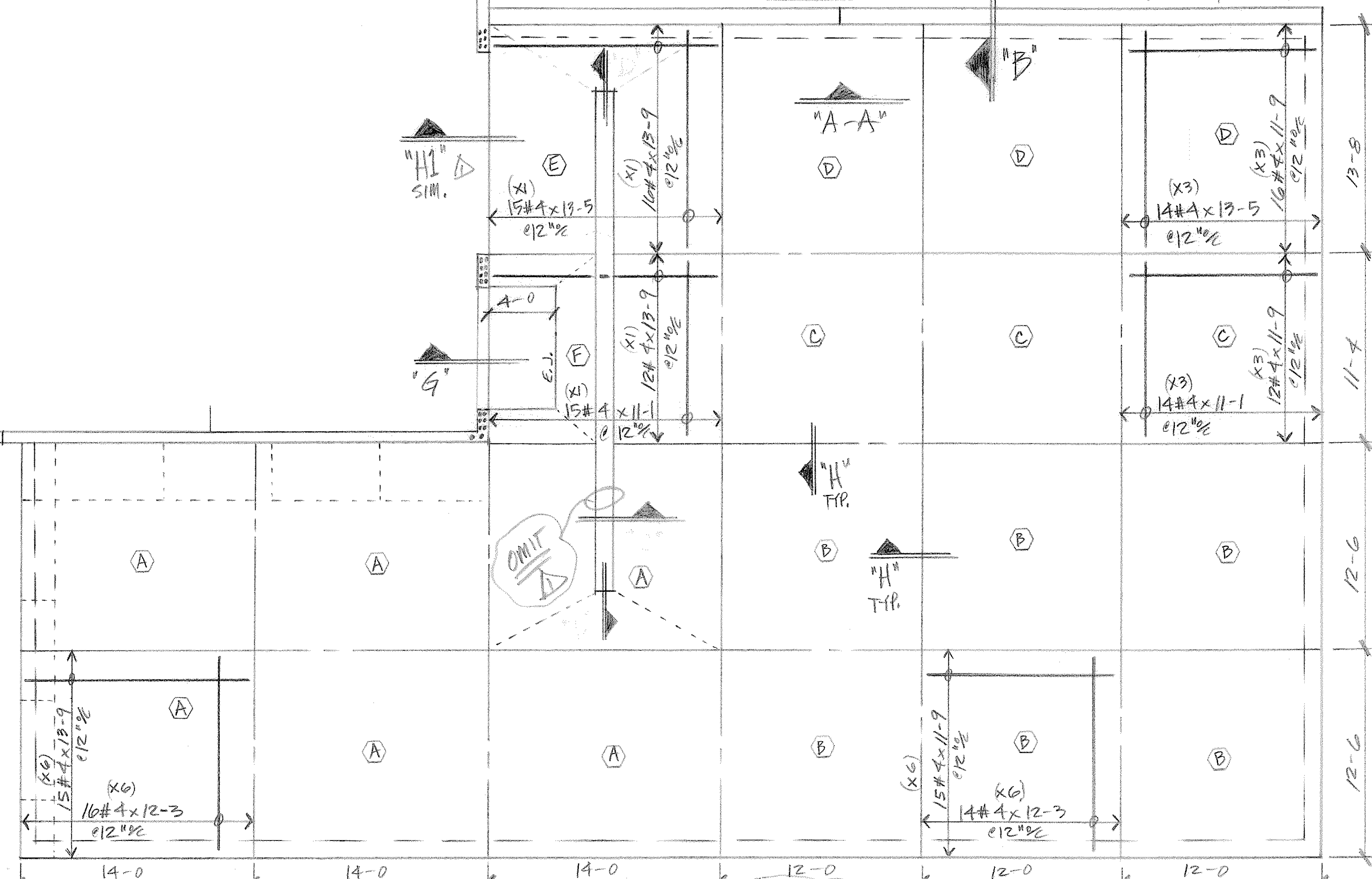
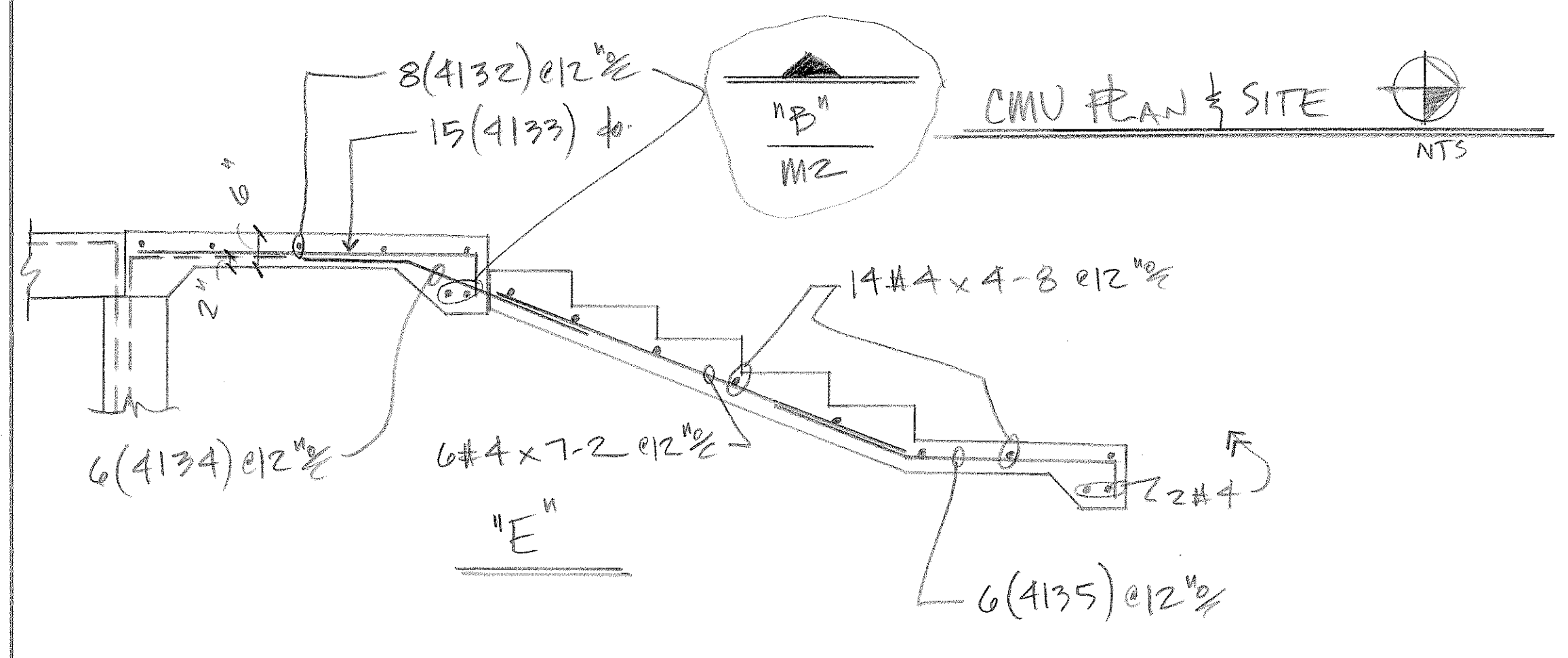

**LEGEND**

- O.F. - OUTSIDE FACE
- I.F. - INSIDE FACE
- E.F. - EACH FACE
- HORIZ. - HORIZONTAL
- VERT. - VERTICAL
- DWLS. - DOWELS
- FTG. - FOOTING
- ELEV. - ELEVATION
- E.W. - EACH WAY
- T.O.F. - TOP OF FOOTING
- B.O.F. - BOTTOM OF FOOTING
- T.O.W. - TOP OF WALL
- B.O.W. - BOTTOM OF WALL
- GRD. BM. - GRADE BEAM
- MK. - MARK
- MAS. - MASONRY
- DIAG. - DIAGONAL
- COL. - COLUMN
- PROJ. - PROJECTION
- T & B - TOP & BOTTOM
- N.F. - NEAR FACE
- F.F. - FAR FACE
- % - ON CENTER
- @ - AT EACH

**REVISIONS**

NO.	DATE	REVISIONS
1	8/2/11	REVISE & RESUBMIT

**DALCO INDUSTRIES, INC.**  
An Employee Owned Company  
AREA CODE 303 371-3950 3730 SALEM ST DENVER, CO. 80239

**JOB:** HAROLD D. THOMPSON RES. WATER RECLAIM.  
**LOCATION:** FOUNTAIN, CO.  
**DESCRIPTION:** CMU BEAM & SITEWORK  
**CONTRACTOR:** WEAVER, CONST.  
**ARCHITECT:** GMS, INC.

DRAWN: D. TAPIN CHECKED: DATE: 3/10/11 REVISIONS: JOB NO. 10082 DRAWING NO. M11/D

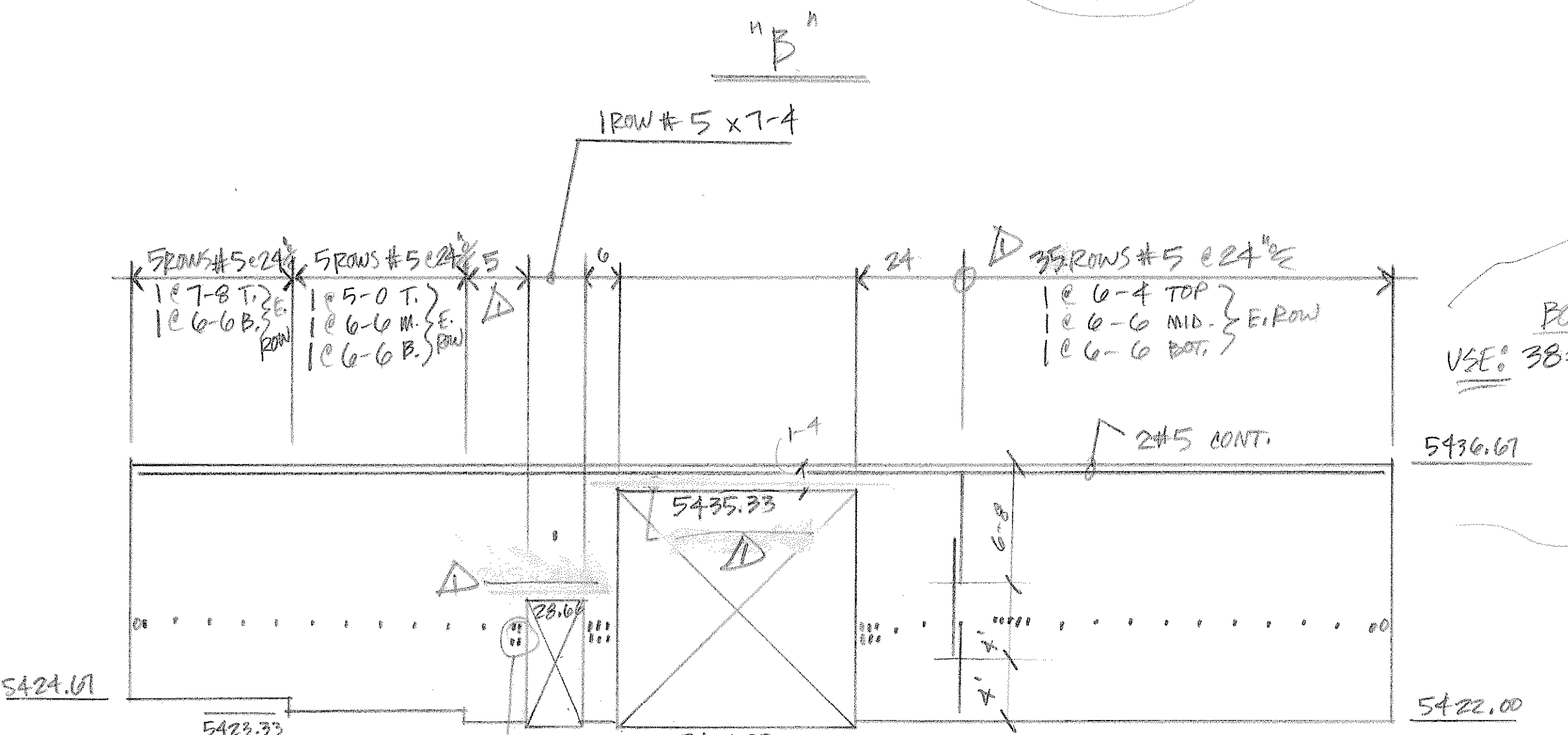
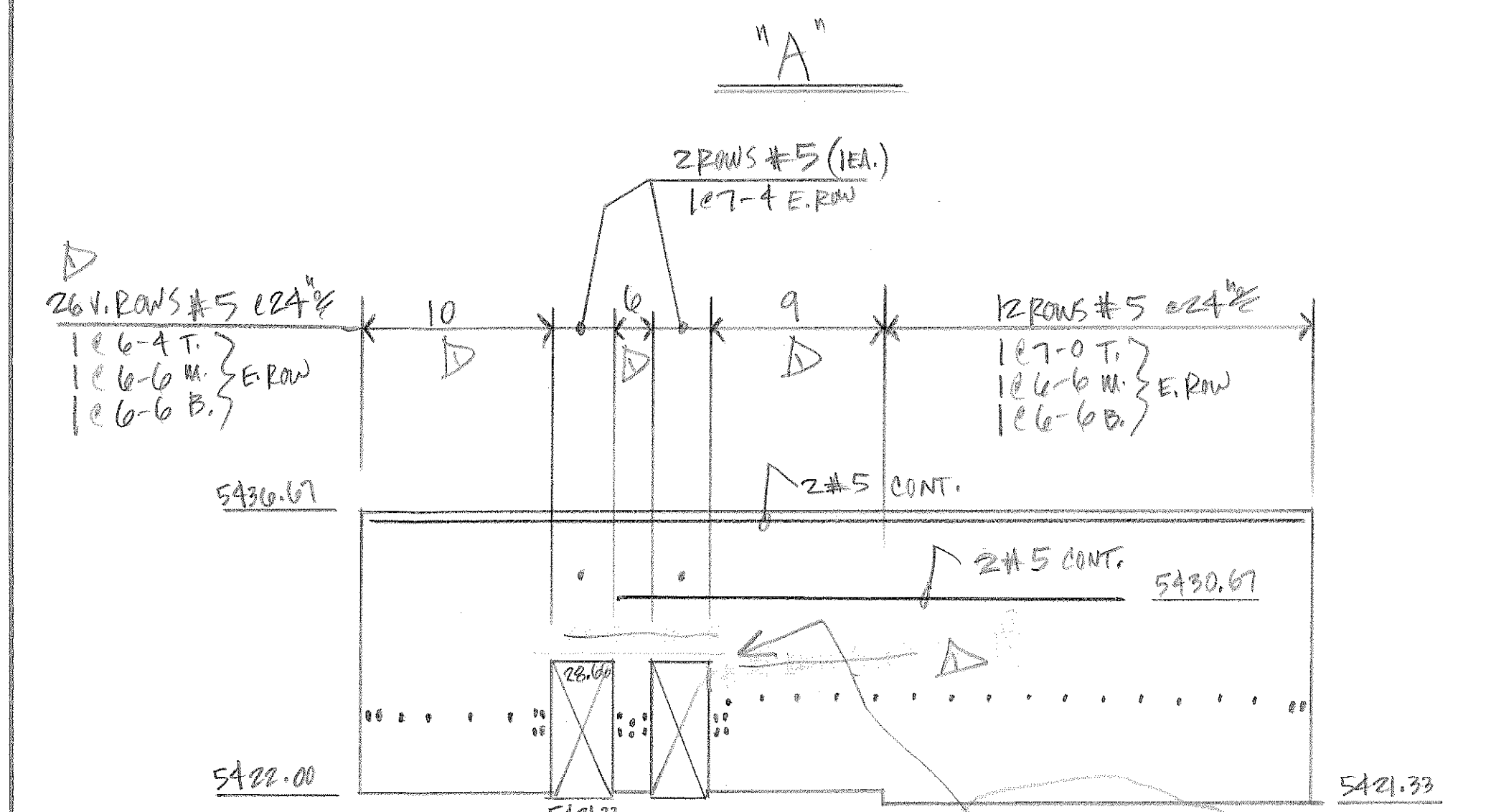
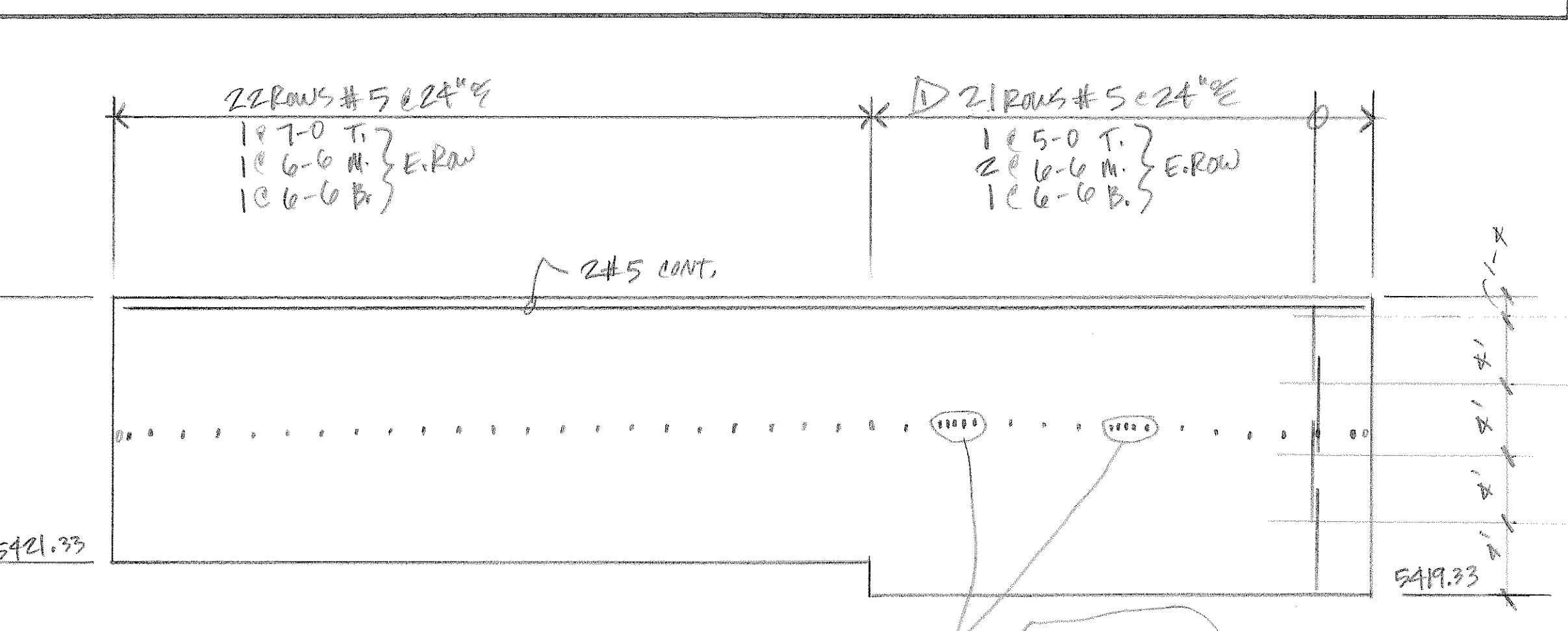
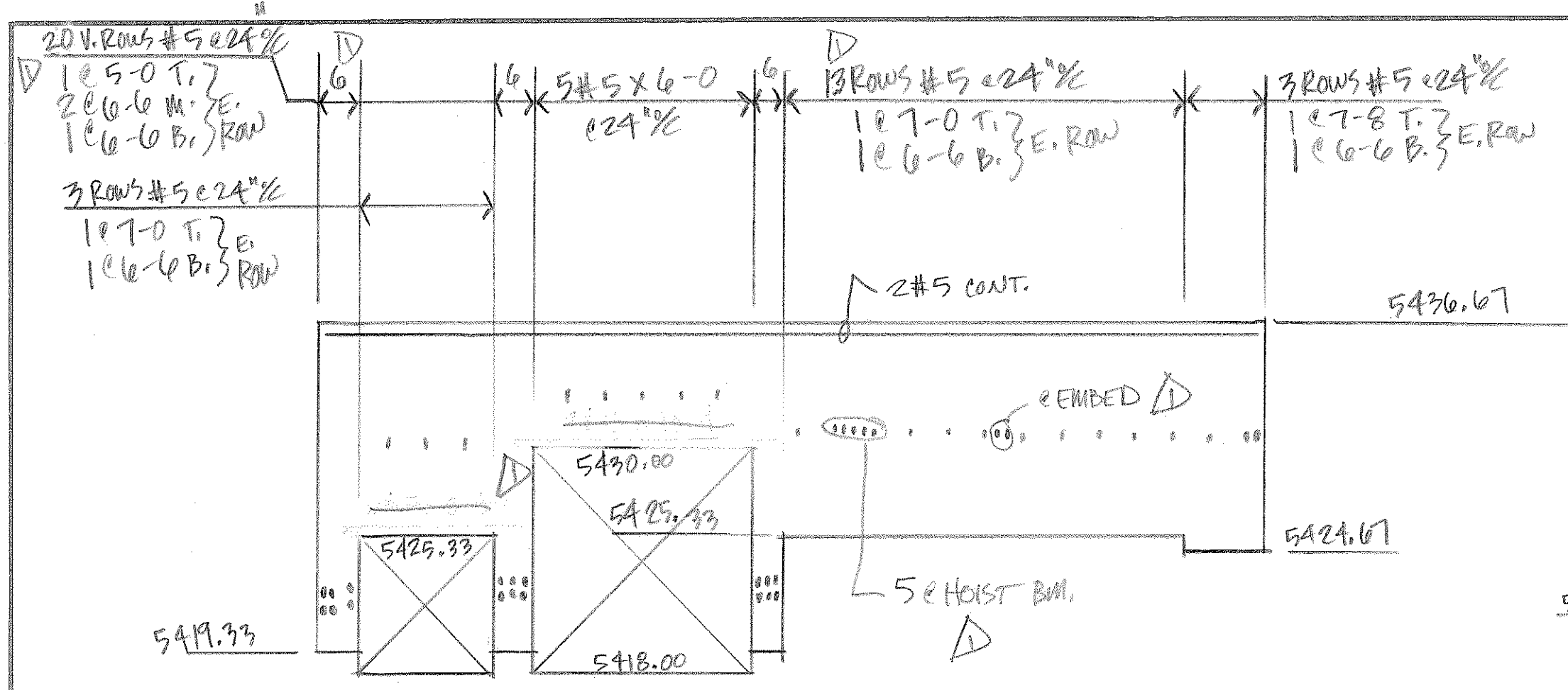

POND BM.  
USE: 38# 5x20±0  
(F-C)  
10(5123) CB'S

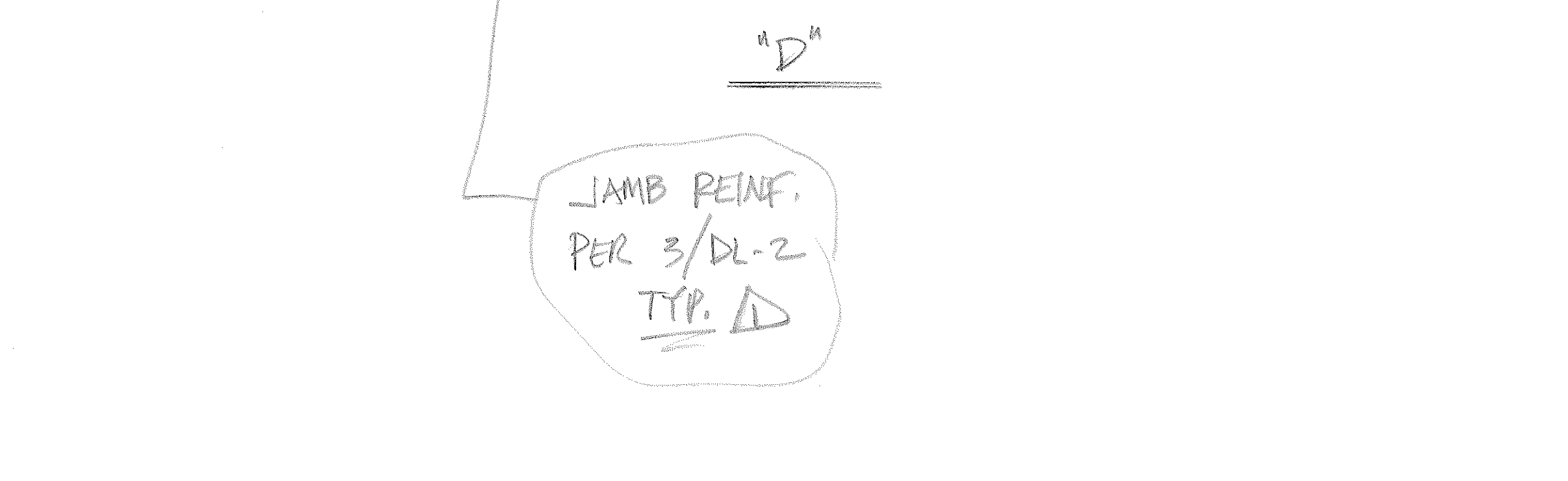
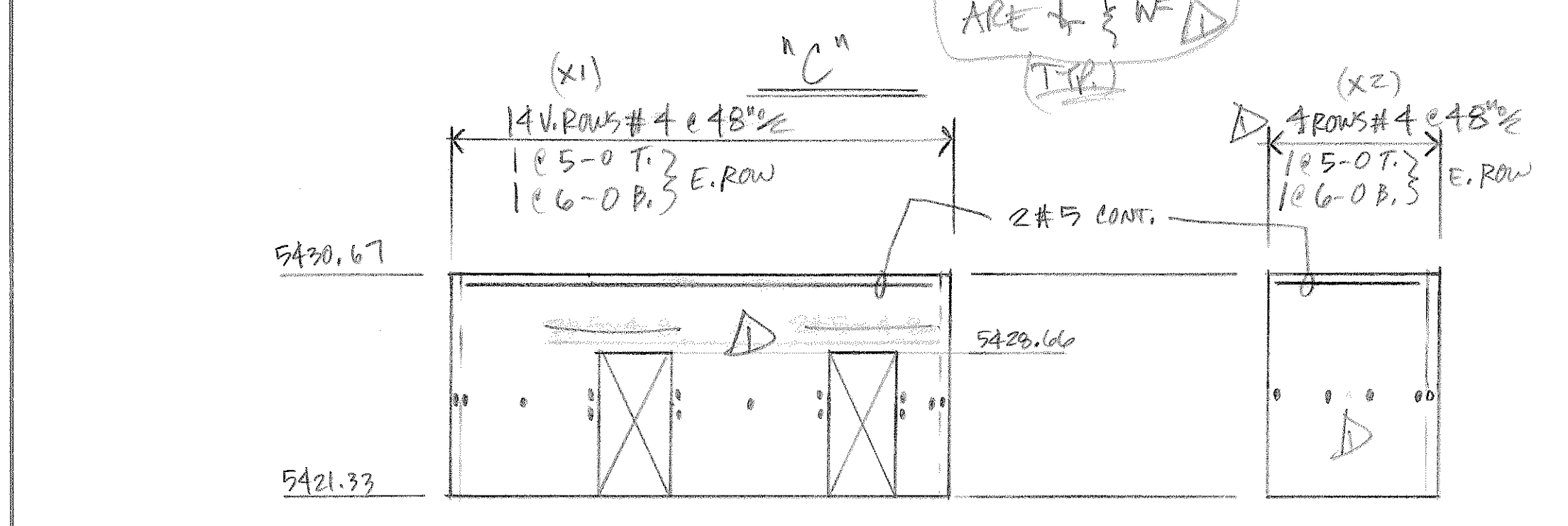

LINTEL STEEL  
ARE 1/2 NF  
TYP.

JAMB REINF.  
PER 3/DL-2  
TYP.

REF. LATEST HW-1 FOR  
MECH. PENETRATIONS THRU  
EAST & WEST CMU WALLS.  
PROVIDE JAMB REINF. PER  
3/DL-2 @ THESE OPN'GS.

LAP (MIN.)  
#4 - 2-0  
#5 - 2-6

F-C = FIELD CUT

LEGEND	
O.F.	OUTSIDE FACE
I.F.	INSIDE FACE
E.F.	EACH FACE
HORIZ.	HORIZONTAL
VERT.	VERTICAL
DWLS.	DOWELS
FTG.	FOOTING
ELEV.	ELEVATION
E.W.	EACH WAY
T.O.F.	TOP OF FOOTING
B.O.F.	BOTTOM OF FOOTING
T.O.W.	TOP OF WALL
B.O.W.	BOTTOM OF WALL
GRD. BM.	GRADE BEAM
MK.	MARK
MAS.	MASONRY
DIAG.	DIAGONAL
COL.	COLUMN
PROJ.	PROJECTION
T & B.	TOP & BOTTOM
N.F.	NEAR FACE
F.F.	FAR FACE
%	ON CENTER
@	AT EACH

NO	DATE	ISSUED FOR
1	8/2/11	REVISE & RESUBMIT
AREA CODE 303 371-3950 3730 SALEM ST. DENVER, COLO. 80239		
JOB HAROLD D. THOMPSON REG. WATER RECLAIM.		
LOCATION FOUNTAIN, CO.		
DESCRIPTION CMU WALL ELEV'S.		
CONTRACTOR WEAVER CONST.		
ARCHITECT SMS, INC.		
DRAWN	CHECKED	DATE
D. TAEN		3/10/11
REVISIONS	JOB NO.	DRAWING NO.
	10082	M2A